

The background of the slide is an abstract composition of light trails and architectural elements. The top half features a dark blue background with bright, curved light trails in shades of blue and white, suggesting a high-speed environment or a tunnel. The bottom half shows a blurred, colorful light trail in shades of blue, green, and yellow, also suggesting motion. A white, semi-transparent rectangular box is centered over the image, containing the main title and subtitle.

FERMAX AU / NZ

Reference Projects

2020 / 2021

DUOX by FERMEX

2 Wires non-polarised



WIRING FLEXIBILITY

DUOX works over any kind of cable; Cat5 or Cat6, 4 core, 6 core and Figure-8 cabling. Install any kind of topology: Star, daisy-chain, distribution.



SIMPLICITY OF INSTALLATION

Same cabling and configuration for audio or video. No distributors or switchers in the main riser.



DIGITAL TRANSMISSION

Immunity against analogue interferences or humming as it is a full digital system.



EASY PROGRAMMING

Easy programming via OSD menu: No dip switches or jumpers needed for monitor's programming. Less than 5 seconds to program a monitor.



SCALABLE SYSTEMS

Capable of distances up to 500m between devices and 999,999 apartments.



PHOTOCALLER PICTURE MEMORY

Photocaller: Picture capture memory by default in all DUOX monitors.



We have been in business in Australia for over 35 years and have in-house qualified electrical and mechanical engineers as part of our technical sales staff that enable us to design and support your most complex installations.

Our business mantra states that we shall work with you and your associates at your convenience to personally take you through our product range onsite or within our showroom as well as providing onsite after sales support as required.

We have an extensive product range that covers the entire security industry;

- Intercom Systems
- Access Control Systems
- CCTV & IP Cameras
- Sound Distribution
- Home Automation
- Intruder Alarm Systems
- Electric Locks
- Networking



Chandos St

Aqualuna

Designed to make the most of every corner aspect, the sophisticated interiors of Aqualuna's residences evoke a timeless luxury.





Blue Lagoon Build by Kyal and Kara



Elizabeth Drive
Liverpool



Yowie Bay



St Ives



Kellyville



Drummoyne



Rose Bay



Summit
Doncaster Hill





Colin & Bates

On a quiet tree-lined street lies a thoughtfully crafted collection of 98 residences in the heart of Chadstone, Collins & Bates. Featuring two individually styled buildings portrayed to convey a sense of distinction and identity the development sees stunning one, two and three bedroom residences which have been meticulously curated and designed by Point Architects, allowing residents to embrace the perfect balance of open spaces, tranquil park lands and luxury fashion.

The Grounds Of Kew

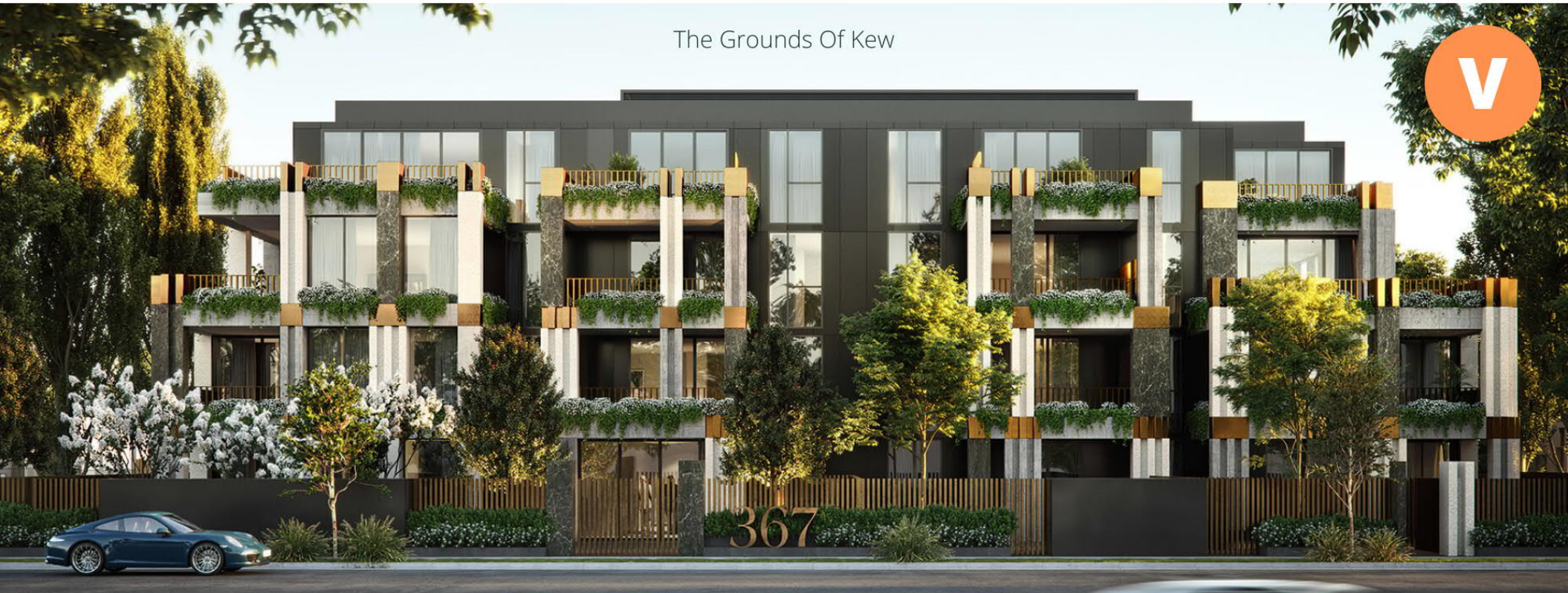

The Selection



The Lyric



Breese Street

Set at the neighbourhood's core, Breese Street is within walking distance of it all and has trains on one hand, trams on the other and one foot already on the cycle path.

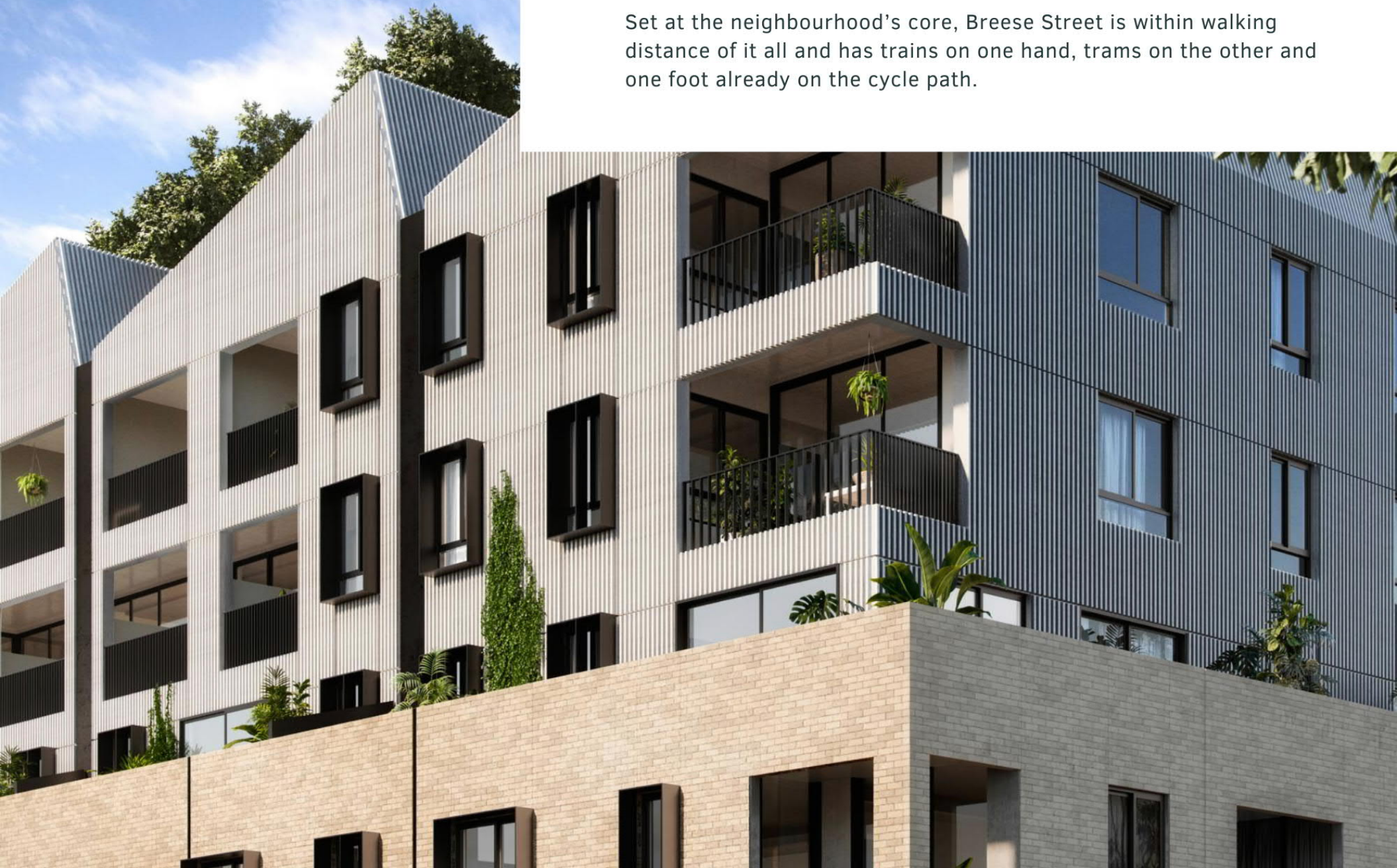

East End





Ceder Ave

It is unique to find a private gated community with such cutting-edge contemporary design, so close to the Jetty Road Café strip and the white sandy beaches of Brighton.





Banskii

Sommerville – Perth



Defined by its coastal location amongst Norfolk Island pines, Somerville epitomises relaxed, beachside living. This intimate, boutique development comprises eight luxurious residences, sitting discreetly in a tree-lined cul-de-sac just 350m from the pristine beaches of Scarborough.





Odin Apartments
Innaloo



Bayswater



Melville



The Avenue

Pallazzo

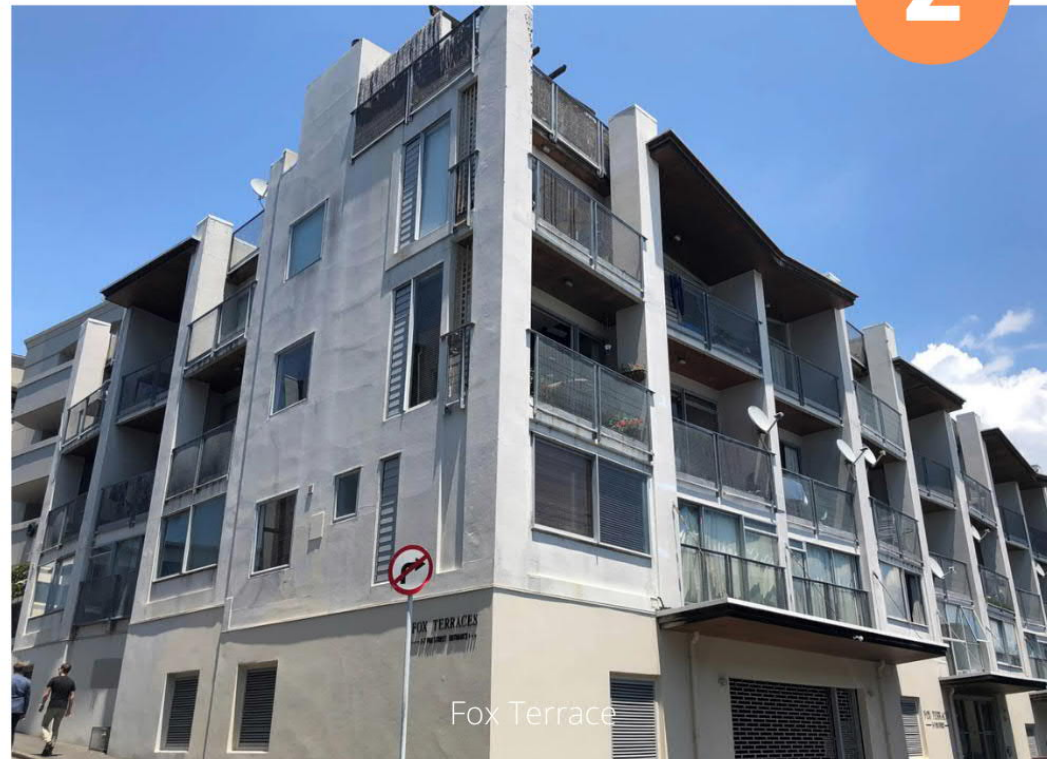

Fox Terrace



Hurstmere Rd



Akoya

The boutique complex is in a coveted location, walking distance to restaurants, cafes and beachfront parks.



Riva



Bondoola

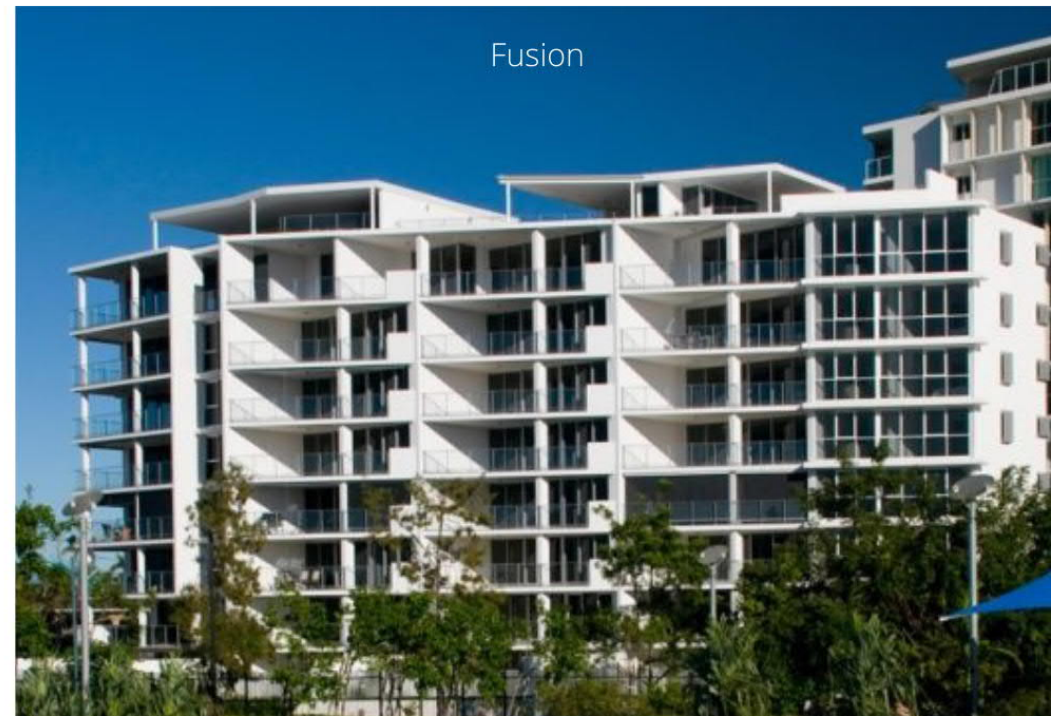

Fusion

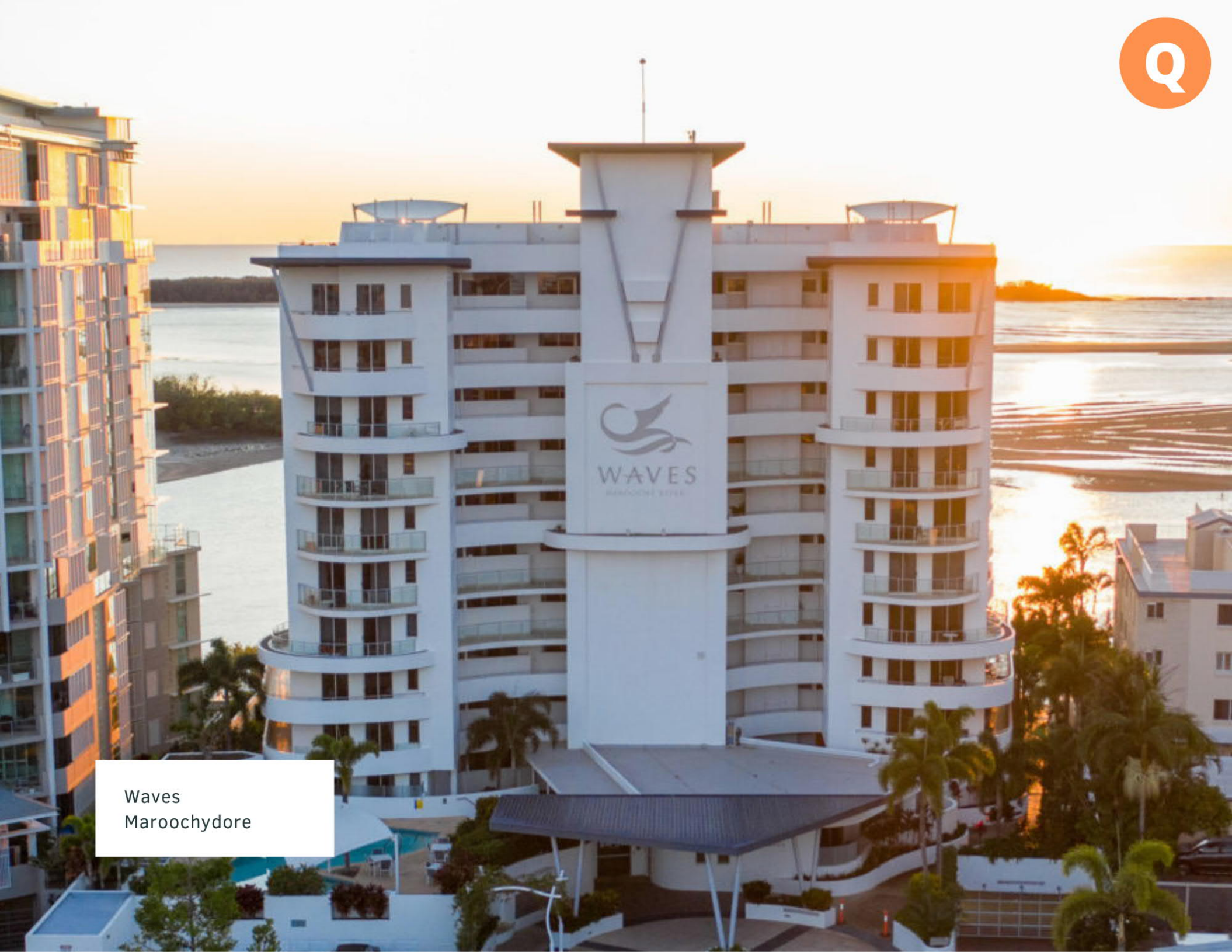

Waves
Maroochydore

N

NSW OFFICE

Unit 1, 37-39 Green St,
Banksmeadow, NSW. 2019
p: 02 9700 1700
e: sales@fermaxaus.com.au

W

WA OFFICE

Unit 2, 26 Gibberd Rd,
Balcatta, WA. 6914
p: 08 9240 2624
e: wa@fermaxaus.com.au

A

ACT OFFICE

PO Box 619,
Fyshwick, ACT. 2609
p: 02 6190 1555
e: act@fermaxaus.com.au

V

VIC OFFICE

Unit 30, 640-680 Geelong Rd,
Brooklyn, VIC. 3012
p: 03 9314 2220
e: vic@fermaxaus.com.au

S

SA OFFICE

PO Box 161,
Torrensville Plaza, SA. 5031
p: 08 7009 4288
e: sa@fermaxaus.com.au

T

NT OFFICE

p: 08 7999 9162
e: nt@fermaxaus.com.au

Q

QLD OFFICE

Unit 11, 8 Fortitude Cres,
Burleigh Heads, QLD. 4220
p: 07 5520 2266
e: qld@fermaxaus.com.au

Z

NZ OFFICE

PO Box 121 110,
Penrose. 1642
p: 09 337 6229
e: nz@fermaxnz.co.nz



FERMAX AUSTRALIA

fermaxaus.com.au

FERMAX NEW ZEALAND

fermaxnz.co.nz